

Warnings

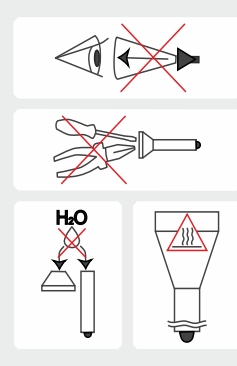

1. Always follow the instructions from this manual and recommendations on battery usage.
2. Apply only the recommended power sources.
3. Do not reverse battery polarity.
4. Do not use different power sources together, i.e. old ones with new ones, charged with discharged. Do not use different types of batteries combined as the element with less capacity can be damaged.
5. Do not modify or recast the flashlight and its components as it will deprive you of the warranty.
6. Do not allow water or any other liquid to leak into the flashlight.
7. Do not aim a switched-on flashlight at people's or animals' eyes – it can cause temporary blindness.
8. Do not allow children to use the flashlight without your assistance.

! The producer will not be liable for any harm done to the user if it was caused by improper use of the product.

Care and Storage

It is recommended to clean the threads and O-rings off dirt and old grease once or twice per year. Remember that reliable protection from water and dust cannot be provided by worn out sealing. The fouling as well as lack of lubricant cause fast wear-out of threads and sealing rings. **To clean the threads do the following:**

1. Unscrew the tailcap and remove the sealing ring carefully with a toothpick (do not use sharp metal things as they can damage the ring).
2. Wipe the sealing ring thoroughly with a soft cloth (or tissue). Do not use solvents. If the sealing ring is worn out or damaged replace it by a new one.
3. Clean the metal threads with a brush using ethanol. Be careful not to allow the applied liquid to get inside the flashlight or tailcap as it can cause fails in functionality of the flashlight.

After cleaning lubricate the thread and the sealing ring with polyalphaolefin-based silica grease, e.g. Nyogel 760G. The application of automotive and other improper grease can cause swelling and damage of the sealing rings.

In case of active operation and exploitation in dusty environments, it is recommended to perform cleaning and lubricating of the parts as often as required.

In case the rubber button is damaged, it should be replaced. You can also replace the switch with the spring in the same way. Replacement order:

1. Unscrew the tailcap.
2. Unscrew the first washer inside it to take out the switch. To do so you should use needle-nose pliers (round-nose pliers or another tool, the most suitable will be expansion pliers). Use the tool as it is shown at the picture. To replace the rubber button unscrew the second washer under the switch.
3. Replace the rubber button and assemble the parts in inverse sequence.

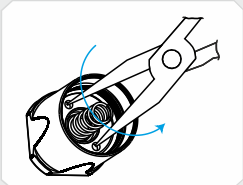

! Do not disassemble the flashlight except for unscrewing the thread ring gage and replacing the rubber button. There are no other parts in the flashlight that can be replaced by the user.

Service and Warranty

Armytek provides free warranty repair for 10 years from the date of purchase.

Warranty doesn't cover damage caused by:

1. Improper usage.
2. Attempts to modify or repair the flashlight by nonqualified specialists.
3. Longtime application in chlorinated or polluted water, or other liquids (other than water).
4. High temperatures and chemicals' exposure (including the exposure of liquid from defected batteries).
5. Usage of low-quality batteries.

Armytek Optoelectronics Inc.

Web: www.armytek.com Email: service@armytek.com

Address: 13-85 West Wilmot St, Richmond Hill, Ontario, L4B 1K7, Canada

Specifications are subject to change without notice.

Predator PRO

THE MOST TECHNICALLY ADVANCED
FLASHLIGHTS IN THE WORLD

USER MANUAL

Thank you for choosing the products of Armytek Optoelectronics Inc., Canada.
Please read this manual carefully before using the flashlight.

Specifications

Armytek Optoelectronics Inc. is a Canadian manufacturer that produces powerful and reliable flashlights designed especially for your needs. The components made in the USA and Japan. **10 years no-hassle warranty.**

- Extreme beam distance up to 450 meters.
- Ultimate brightness – 1700 LED lumens.
- Constant brightness even in -25°C frost and with almost discharged batteries.
- Distinct hotspot and minimal spill guarantee directed aim illumination.
- Standard 1" body diameter matches up with most weapon mounts.
- Reliable body, red/green/blue filters and original remote switches for comfortable Hunting and secure Military application.
- Guaranteed durability – stands up the recoil of any gun gauge and falling from 30 meters height.
- The flashlight works for more than 5 hours at 50 meters depth.

Model	Predator Pro XHP35 HI	Predator Pro XP-L HI	Predator Pro XB-H	
LED	Cree XHP35 High Intensity	Cree XP-L High Intensity	Cree XB-H	
Optics	Smooth Reflector			
Brightness stabilization type	FULL (constant light)			
Light output, LED / OTF lumens*	1700 / 1400	1200 / 1000	700 / 550	
Peak beam intensity, candelas	50750	47750	36200	
Hotspot / spill	5° / 40°	5° / 40°	4° / 40°	
Beam distance*	451 meters	437 meters	380 meters	
Modes and runtimes (measured with 18650 Li-Ion 3400mAh until the light output drops to 10% of the initial value)	Turbo2	1400 lm / 1h	1000 lm / 1.3h	550 lm / 1.7h
	Turbo1	800 lm / 1.7h	670 lm / 1.8h	400 lm / 1.8h
	Main3	350 lm / 4h	370 lm / 3.5h	310 lm / 3.5h
	Main2	150 lm / 10.5h	170 lm / 8.5h	150 lm / 8.5h
	Main1	30 lm / 50h	28 lm / 36h	30 lm / 36h
	Firefly2	1.7 lm / 40d	1.7 lm / 18d	2 lm / 18d
	Firefly1	0.15 lm / 200d	0.35 lm / 100d	0.2 lm / 100d
	Strobe2	15 Hz / 1400 lm / 2h	15 Hz / 1000 lm / 2.7h	15 Hz / 550 lm / 3.3h
Strobe1	15 Hz / 150 lm / 22h	15 Hz / 170 lm / 17h	15 Hz / 150 lm / 17h	
Power source	1x18650 Li-Ion / 2x18350 Li-Ion / 2xRCR123 Li-Ion / 2xCR123A			
Size and weight (without batteries)	Length 154mm, body diameter 25.4mm, head diameter 41mm, weight 135g			

* Light output for flashlights with Warm light are about 7% less, beam distances are about 3% less.

! We DO NOT RECOMMEND to use low-quality CR123A batteries, because they can explode. Turbo mode needs rechargeable 18650 Li-Ion batteries without PCB (unprotected) or with PCB which guarantees 7A discharge current for stable work.

Set description



Items included in the package:

- | | |
|--------------------|-------------------------|
| 1 - Flashlight | 6 - Holster |
| 2 - Clip | 7 - Spare rubber button |
| 3 - 2 rubber rings | 8 - 2 spare O-rings |
| 4 - Rubber grip | 9 - User manual |
| 5 - Lanyard | |

- ! Your flashlight can inconsiderably differ from the pictures in the manual.
- ! The producer reserves the right to change the package at his own discretion without modifying this manual.

Initial Service

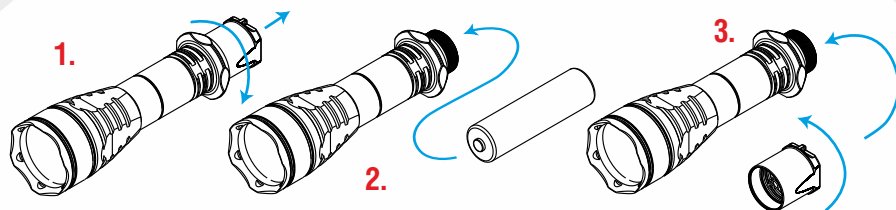

To set/replace batteries:

1. Unscrew the tailcap.
2. Place the batteries with the positive contact (+) facing the head of the flashlight.
3. Adjust the tailcap and tighten it as far as it can go.

- ! We DO NOT RECOMMEND to leave power sources inside the flashlight for a long storage period, as batteries (especially, non-rechargeable) can leak for various reasons and damage the inner parts of the flashlight. If you want to keep your flashlight in a stand-by state with batteries in then use new and high-quality batteries and store the flashlight in acceptable for batteries operational temperature and revise the batteries' state at least once a month. If you have noticed any signs of batteries' defects then withdraw them from the flashlight and utilize. It is also recommended to replace discharged batteries with new ones before the storage as the chance of leakage is higher with discharged batteries.

Active temperature control. The flashlight can quickly heat up in Turbo mode. When the temperature becomes +60°C – the brightness decreases by small steps. After cooling-down (provided that battery voltage is sufficient) the brightness increases to the Turbo mode again. This stepping goes cyclically to maintain the user's safety and the flashlight's functionality. In conditions of good air-cooling the flashlight delivers light without stepping down even in Turbo mode. There are no preset timers for stepping, but real-time active temperature measurements.

Operation

Change Hunting/Tactical settings

Unscrew & Tighten up x10

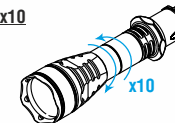

Constant light

Tighten up



Turbo

Click x1



Strobe

Unscrew to 1/8



Additional modes

Click x1



Cycling through Additional modes

Half Press & Release (no click)

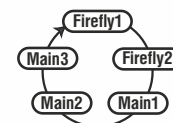

Unscrew & Tighten up

Turbo
↑
↓
Main2

Change Constant modes

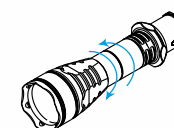

Tighten up & Unscrew

Strobe2
↑
↓
Strobe1

Change Strobe modes

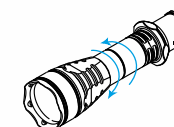

How to change Turbo1 & Turbo2

Half Press & Release (no click)



Momentary on – any mode switched on by half-pressing of the button (no click!) and active till the button is released. It is suitable for giving signals by short button pressings. Click the button to switch the light on permanently.

Hunting settings – comfortable modes for hunting. It's set by default. Turbo mode (when the head is tightened up) and Additional modes with constant light (changed by click with the head unscrewed to 1/8). Remote switch can be used in Turbo.

Tactical settings – made for Special forces and Airsoft. Constant light (when the head is tightened up) and Strobe mode (when the head is unscrewed to 1/8). There are 2 Strobe modes and 2 Constant light modes for selection. Remote switch can be used in ANY mode.

How to change the settings from one to another – unscrew and tighten up the head of the flashlight at least 10 times (while rotation you will change the modes). The pause must be <1 sec.

Hunting settings:

Turbo. Tighten the head of the flashlight if it is unscrewed. First full click of the button turns the light on. Second full click turns it off.

Additional modes (2 Firefly + 3 Main). If the head of the flashlight is tightened up, unscrew it for 1/8 of a circle. Full click of the button turns the light on at the last used Additional mode.

Cycling through Additional modes. To switch the mode turn the flashlight off and on (by full click or half-pressing). The modes switch cyclically: Firefly1 – Firefly2 – Main1 – Main2 – Main3.

Tactical settings:

Constant light. Tighten the head of the flashlight if it is unscrewed. First full click of the button turns constant light on. Second full click turns it off. Also you can switch it on by half-pressing of the button (no click).

Strobe. If the head is tightened up, unscrew it for 1/8 of a circle. First full click of the button turns Strobe on. Second full click turns it off. Also you can switch it on by half-pressing of the button (no click).

Change Constant modes. The head is tightened up: unscrew it for 1/8 and tighten up again – Turbo and Main2 will switch cyclically.

Change Strobe modes. The head is unscrewed: tighten up and unscrew it for 1/8 again – Strobe1 and Strobe2 will switch cyclically.

How to change Turbo1 & Turbo2. There are two Turbo modes. You will use only one, but can select which one. Turbo2 is boost mode for maximal brightness and set by default. Turbo1 is constant brightness mode (more powerful than Main modes). Half press & release the button (without click) at least 15 times. The flashlight must be switched on at the end of these actions. The light will flash 1 or 2 times to show the number of Turbo chosen.

Automemorizing. After switching off the last used Mode is memorized for quick 1-click access at next switching on.

Lock-out function. Unscrew the tailcap to 1/4 for the protection from accidental switching on.

Low Battery Indication. If the brightness is <25% from the nominal value, the LED flashes 2 times ONCE (after 30sec from switching on). If you are not sure if it flashed or not switch the flashlight off and on: in case the battery is low flashes will repeat. Light output decreases to Firefly mode at critical level.